

10

MODIFICATION OF AN EXISTING PPS SYSTEM

A) When planning modifications of an existing system, make sure to follow the guidelines provided in the PPS Design Guide.

B) To disassemble a fitting, unscrew the nuts completely and gently pull out the pipes.

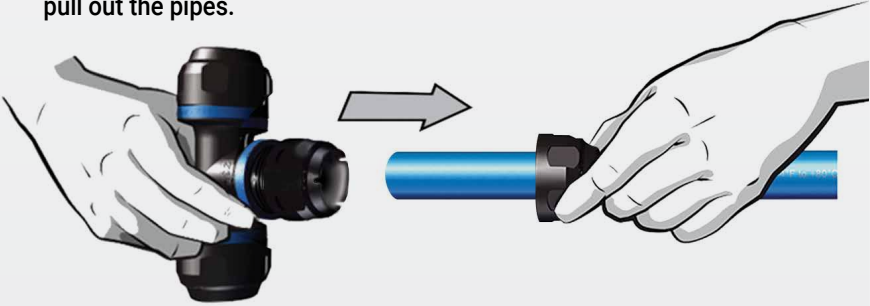

C) Inspect the condition of the pipe

If the pipe's painted surface is scratched, it can cause air leaks. If needed, cut away the damaged section, re-chamfer and clean the pipe (see steps 2 and 3).



D) Inspect the fitting

Replace the whole fitting if the body or nuts are deformed or cracked. Internal parts and air seals must be replaced each time the fitting is disassembled. See Topring PPS Catalog for replacement parts (08.770 to 08.777 and 08.780 to 08.787).



Replacement parts

E) Follow Steps 1 to 9, as for the initial installation.

⚠ WARNING
CHECKING BEFORE PRESSURIZING / RESIDUAL RISK

Without respecting the safety information and requirements provided in this document, an inadequate assembly of the system can result in:

- Under pressure fluid ejections, in case of disconnection caused by inadequate tightening.
- Under pressure fluid ejections, in case of damage to the pipe caused by shocks.
- Under pressure fluid ejections, if the operating pressure is higher than 232 PSI (16 BAR).

When identified, defective parts must be repaired immediately.

PRESSURIZING (TWO PHASES)

- 1- Run a preliminary test by gradually raising the pressure to a maximum of 43.5 PSI (3 BAR). This will allow the operator to identify leaks or faulty connections and make the necessary corrections. Gradual pressurization will also remove all the aluminium residue in the system.
- 2- Gradually and continuously increase the pressure, 14.5 PSI (1 BAR) every 5 seconds, until it reaches the working pressure.

PRESSURIZING VERIFICATION

- 1- Once the working pressure has been reached, maintain working pressure for at least 10 minutes (slight dips are tolerated).
- 2- After the first 48 to 72 hours, check all seals and verify that nuts are secured.

⚠ WARNING
THE PIPING SYSTEM SHOULD NEVER SUPPORT LOADS OTHER THAN ITS OWN WEIGHT, OR BE EXPOSED TO MOVEMENT OTHER THAN THE NORMAL EXPANSION OF ITS COMPONENTS. WHEN PLANNING THE LAYOUT OF A WORKSTATION, FLEXIBLE HOSES SHOULD BE CONNECTED THROUGH STURDILY ATTACHED HOSE REELS OR MANIFOLDS TO ISOLATE PIPING FROM TOOL WEIGHT AND MOVEMENT.

MAINTENANCE

Here is a list of recommended checks and controls by TOPRING:

- Review the status of the installation on an annual basis.
- Check the tightening of the nuts.
- In the event of an impact, check the condition of the pipe and replace any damaged parts.
- Check for air leaks.

⚠ WARNING
ANY TYPE OF INTERVENTION MUST BE CARRIED OUT ON A DEPRESSURIZED SYSTEM OR DEPRESSURIZED SECTION (USING A QUARTER TURN BALL VALVE OR A LOCKABLE SAFETY VALVE).

LIABILITY OF ALL BUYERS AND/OR USERS

In addition to carefully reading the TOPRING design guide, product guidelines, system and/or network (hereinafter referred to as « TOPRING Product(s) »), purchasers and/or users of a TOPRING Product that involves compressed air must inquire, prior to its use, about the health and safety risks associated with compressed air.

Buyers and/or users acknowledge that by purchasing and using a TOPRING Product, they understand and accept that he or she is solely responsible for the installation, identification, maintenance, and use of the TOPRING Product, as well as the configuration of any system or network that uses a TOPRING Product. Subject to the limits of public policy as expressed in the law, buyers and/or users assume any risk and liability that may arise from loss, damage or injury caused by the improper installation, identification, maintenance and/or use of a TOPRING Product, or caused by a misconfiguration of any system or network using a TOPRING Product, to the extent to completely and entirely exonerate TOPRING, as well as its subsidiaries and affiliated corporations (hereinafter referred to as « TOPRING »). Buyers and/or users must take into consideration among other factors, the regulations in force, the use of any TOPRING Product, preventative measures, as well as the particular nature of the premises or location, and the activities or operations that take place.

By purchasing a TOPRING Product, and subject to the limits of public policy expressed in the law, you hereby acknowledge and agree that TOPRING cannot be held liable for any damages whatsoever (including damages caused by loss of profits, business interruption or loss of information or otherwise) arising from the improper installation, identification, maintenance and/or use of a TOPRING Product, or the improper configuration of any system or network that uses a TOPRING Product, or arising from the unfeasibility of such a configuration, installation, identification, maintenance and/or use.

Purchasers and/or users of a TOPRING Product are responsible for communicating with any person that may be concerned the extent of the risk, as well as any warnings and preventative measures relating to TOPRING Products, including but not limited to employees using one or more TOPRING Products.